

**WTQ1 SH32/SH32A  
ROLLINGSTONE  
SPECIAL**  
EDITION 1

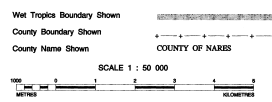

WET TROPICS  
WORLD HERITAGE AREA



Land Office District Northern  
Local Authority Cairns, Thuringowa  
1:50 000 Rollagstone 8159-1  
Ben Lomond 8159-2 (R)  
Base Mapping Digital Cadastral Data Base,  
Queensland Department of  
Lands as at 1997  
Land Tenure Data within World Heritage Area  
are current as at 1 Oct 1992,  
as extracted from the  
Queensland Dept. of Lands,  
Queensland Dept. of Forestry Industries  
Queensland Dept. of Minerals and Energy  
Date of Preparation 14 Oct 1992  
Datum C.A.M.

The boundary of the Wet Tropics of Queensland World Heritage Area along the  
line of the coastline, as indicated on a 1:50,000 scale map, shall be the line of  
water springs the high water average of the height of two successive low  
waters during each period of 24 hours when the range of the tide is greatest,  
commonly known as the low water mark.

*A. Robson*  
The Hon. Moly Robson, M.A.  
Chairman,  
Wet Tropics Ministerial Council  
and Secretary,  
Wet Tropics Management Authority

*P. Hinch*  
Peter Hinch AM  
Secretary,  
Wet Tropics Ministerial Council  
and Secretary,  
Wet Tropics Management Authority

Prepared to delineate the boundaries of the Wet Tropics of Queensland,  
World Heritage Area under the provisions of the World Heritage Convention  
(UNESCO) and the Wet Tropics Heritage Management and Protection  
Act (Qld), and the Administrative Boundaries Terminology Act 1989 (Qld).

Prepared under the direction of the Wet Tropics Management Authority by  
Mr Mark and Dr Glenn based on the World Heritage boundary as shown on the  
1:50,000 cadastral map series - catalogue M2375, sheets 1 to 13 deposited  
with Australia's Surveying and Land Information Group, Queensland  
Department of Administration Services, Brisbane. Additional assistance and  
information supplied by AGLIS and Commonwealth Department of the Arts, Sport,  
the Environment and Territories (DSRST).

CROWN COPYRIGHT RESERVED

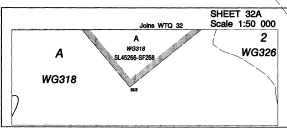
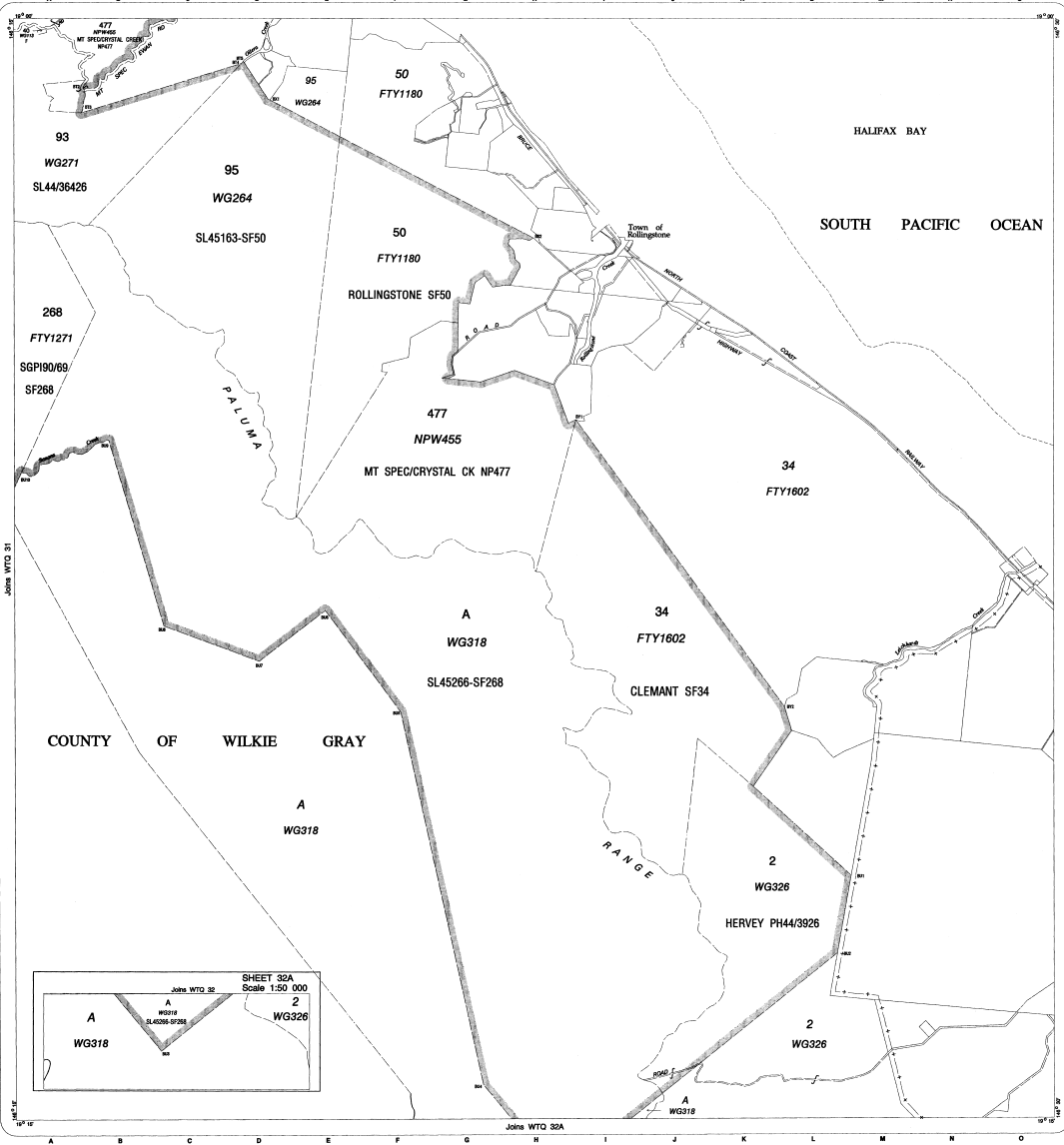

**WTQ1 SH32/SH32A ROLLINGSTONE SPECIAL INDEX**

LOT	PLAN	NAME	INDEX
50	FTY1180	ROLLINGSTONE SF50	.....F4
268	FTY1271	SGP190/69 SF268	.....A5
34	FTY1602	CLEMANT SF34	.....B9
477	NPW455	MT SPEC/CRYSTAL CK NP477	.....B1
477	NPW455	MT SPEC/CRYSTAL CK NP477	.....G6
40	WG113	F	.....A1
95	WG264	SL45163-SF50	.....D3
95	WG271	SL45163	.....B2
A	WG318	SL45266-SF268	.....C9
A	WG318	SL45266-SF268	.....C14(SH32A)
2	WG326	HERVEY PH44/3926	.....K12

**WTQ1 SH32/SH32A ROLLINGSTONE SPECIAL TABULATIONS**

LINE	BEARING	DISTANCE
BT1-BT2	Mount Spec Ewan Road	Abt 4300.0
BT3-BT4	Abt 67° 0'	Abt 4200.0
BT4-BT5	Abt 37° 15'	Abt 50.0
BX1-BX2	Abt 111° 30'	Abt 7500.0
BY1-BY2	Abt 138° 0'	Abt 8930.0
BU1-BU2	184° 11'	Abt 2000.0
BU2-BU3	Abt 225° 15'	Abt 9000.0
BU3-BU4	Abt 313° 0'	Abt 2990.0
BU4-BU5	Abt 341° 45'	Abt 9650.0
BU5-BU6	Abt 317° 0'	Abt 3150.0
BU6-BU7	Abt 226° 45'	Abt 2100.0
BU7-BU8	Abt 284° 0'	Abt 5000.0
BU8-BU9	Abt 337° 30'	Abt 4850.0
BU9-BU10	Barama CK	Abt 2550.0
BU10-BU11	Abt 205° 0'	Abt 1000.0

**WTQ1 SH32/SH32A  
ROLLINGSTONE  
SPECIAL**

**WORLD HERITAGE AREA  
BOUNDARY PLAN**



WET TROPICS  
WORLD HERITAGE AREA